

Sky and stage

Tower MT1

MT1 is ideal for most rigging projects in Entertainment and Event environments.

The MT1 Tower is designed for use with the Quick-Truss® M290, M390 and M400 (using special adapter) systems. Also, it serves as the basic unit for Milos Roof Systems MR2 Series. Able to support 1000 kg (2204.6 lbs), the MT1 Tower is useful for many reasons. Truss spans can be prerigged at ground level and winched up, manually with hand chain hoist or electrically with an optional motor hoist to a maximum height of up to 7,5 meters (24.6').

height m [ft]	7,50	24.60
capacity with hoist kg [lbs]	1000	2204.60
self weight kg [lbs]	210	463

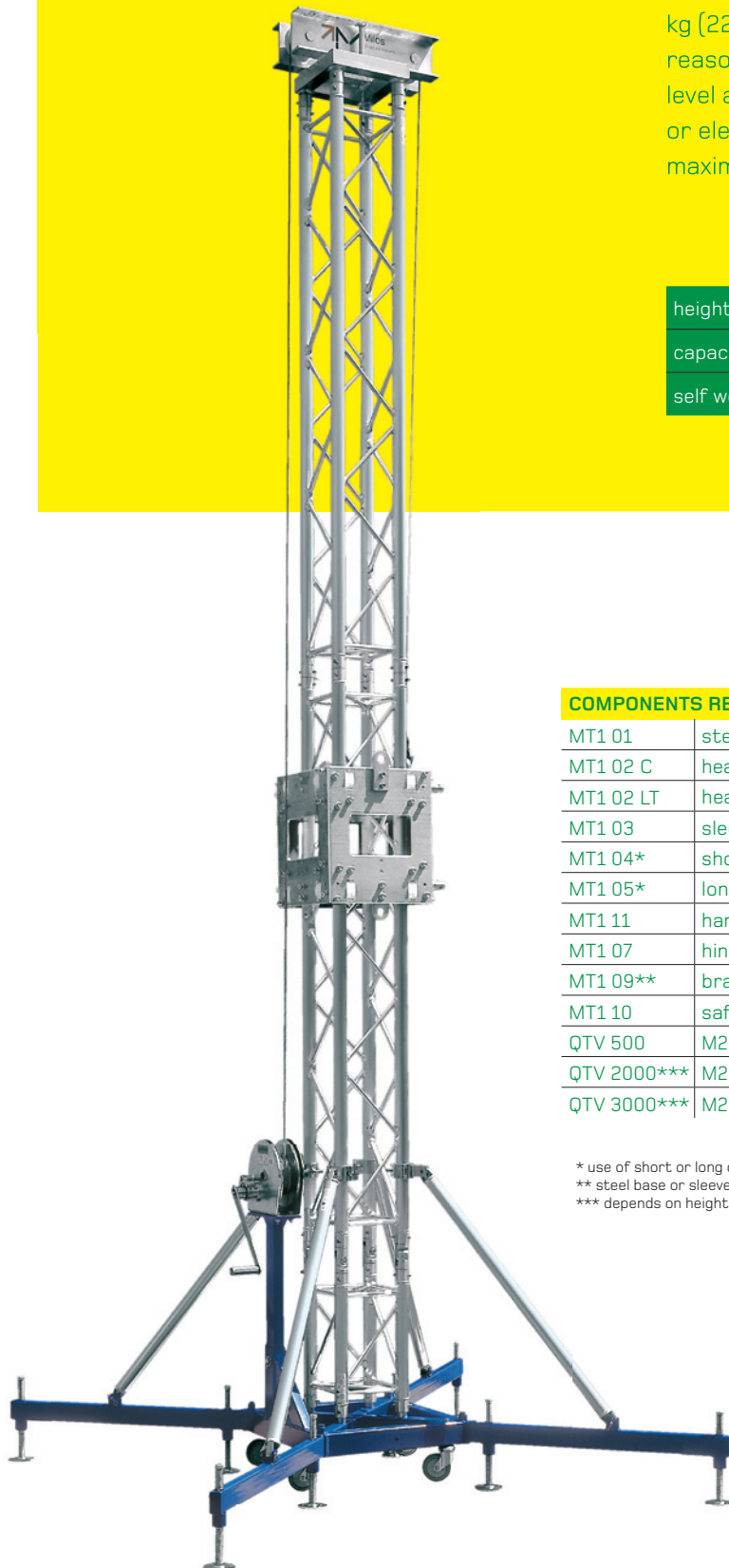

COMPONENTS REQUIRED TO CONSTRUCT ONE MT1 TOWER

MT1 01	steel base MT1	1 piece
MT1 02 C	head section MT1 (chain/wire)	1 piece
MT1 02 LT	head section MT1 (for hand-chain block)	1 piece
MT1 03	sleeve block MT1	1 piece
MT1 04*	short outrigger MT1	4 pieces
MT1 05*	long outrigger MT1	4 pieces
MT1 11	hand chain hoist	1 piece
MT1 07	hinge parts	1 set = 4 pieces
MT1 09**	bracket for motor	1 piece
MT1 10	safety wire	1 piece
QTV 500	M290V quatro 0,5 m length	1 piece
QTV 2000***	M290V quatro 2 m length	2 piece
QTV 3000***	M290V quatro 3 m length	1 piece

* use of short or long outrigger depends on the tower's application

** steel base or sleeve block attachment

*** depends on height requirements (max. height is 7,5 m / 24,6')

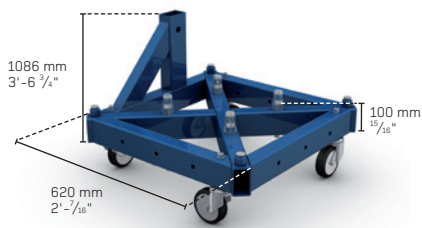

MT1 01 STEEL BASE

A robust steel base ensures adequate stability for the tower. The base has wheels which allows for easy movement during setup.

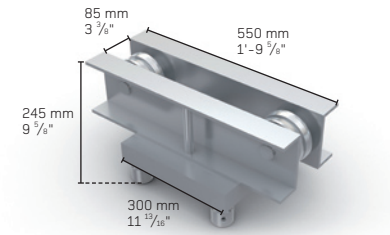

MT1 02 C HEAD SECTION

Fitted with pulleys that will accommodate a chain.

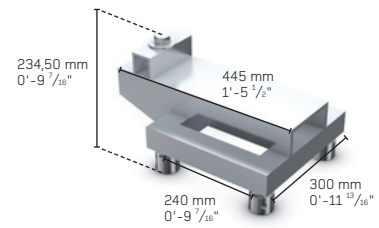

MT1 02 LT HEAD SECTION

Serves for hand chain block use.

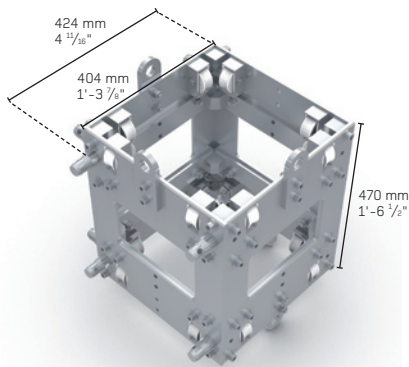

MT1 03 SLEEVE BLOCK

A combination of aluminum and steel, the block consist of 10 mm (0.39") aluminum plates that are connected with steel components. The block allows for connection of QuickTruss® M290 and M390 Systems.

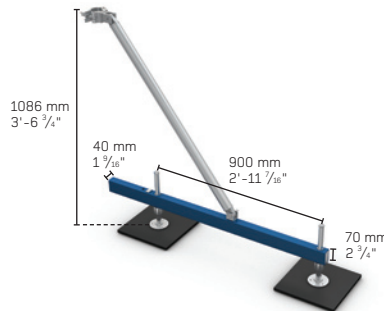

MT1 05 LONG OUTRIGGER

Long outrigger is 1,2 meters (3.94') long, including levelers to accommodate uneven surfaces.

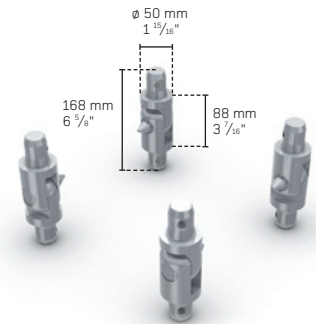

MT1 07 HINGE PARTS

Used to connect the vertical Quatro pieces together and to allow for tilt-up assembly. 4 off Hinge Parts per set.

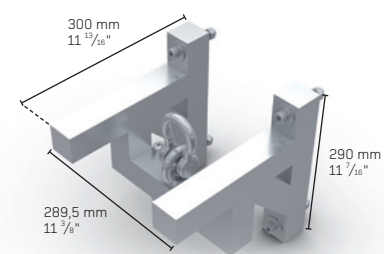

MT1 09 BRACKET FOR MOTOR

Can be used for motor attachment to sleeve block to achieve max. loading characteristics.

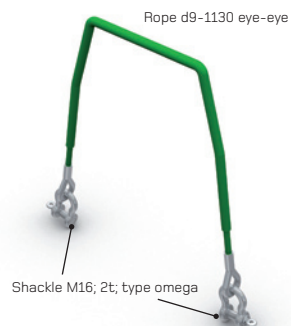

MT1 10 SAFETY WIRE

Use with MT1 to secure sleeve block.



MT1 11 CM HAND CHAIN HOIST

Manually powered CM chain hoist which raises or lowers a load.