

Capacity and possibilities

4GS-62 / 4GS-62F



Our 4GS-62/62F range of modular aluminium systems provides reliable high capacity support for touring productions. The tried, tested & trusted traditional fork & tongue connection is popular with rental companies worldwide with great performance and durability.

The 4GS-62F folding format combines great free-span and load capacity with incredible space saving for storage and transportation.

A wide range of standard lengths are available plus special fabrication facilities and finish options.



4GS-62

connection type	fork end connection	tubes	48 x 4,5 mm	1 7/8" x 3/16"	braces	25 x 3 mm 32 x 3 mm	1" x 1/8" 1 1/4" x 1/8"	alloy	EN - AW 6082 T6
------------------------	---------------------	--------------	-------------	----------------	---------------	------------------------	----------------------------	--------------	-----------------

Circles and special structures available. Powder coating to RAL reference.

4GS-62																		
Span in m (ft)	4,00	13.12	6,00	19.69	8,00	26.25	10,00	32.81	12,00	39.37	14,00	45.93	16,00	52.50	18,00	59.06	19,00	62.34
point load in kg (lbs)	5014,80	11057,63	3323,20	7327,66	2471,40	5449,44	1955,50	4311,88	1607,60	3544,76	1355,70	2989,32	1163,70	2565,96	1011,70	2230,80	946,80	2087,69
deflection in mm (inch)	7,00	0,27	13,00	0,51	23,00	0,90	35,00	1,37	51,00	1,99	69,00	2,69	91,00	3,55	115,00	4,49	128,00	4,99
two point load in kg (lbs)	3700,80	8160,26	2492,40	5495,74	1853,50	4086,97	1466,60	3233,85	1205,70	2658,57	1016,70	2241,82	872,80	1924,52	758,80	1673,15	710,10	1565,77
deflection in mm (inch)	7,00	0,27	16,00	0,62	29,00	1,13	45,00	1,76	65,00	2,54	88,00	3,43	116,00	4,52	146,00	5,69	163,00	6,36
distrib. loading in kg/m (lbs/ft)	1850,40	1243,56	1107,70	744,43	617,80	415,19	391,10	262,84	267,90	180,04	193,70	130,18	145,50	97,78	112,40	75,54	99,70	67,00
total distrib. loading in kg (lbs)	7401,60	16320,53	6646,20	14654,87	4942,40	10897,99	3911,00	8623,76	3214,80	7088,63	2711,80	5979,52	2328,20	5133,24	2023,20	4461,16	1894,30	4176,93
deflection in mm (inch)	7,00	0,27	16,00	0,62	28,00	1,09	44,00	1,72	64,00	2,50	87,00	3,39	113,00	4,41	143,00	5,58	159,00	6,20

STANDARD LENGTHS AVAILABLE AND WEIGHTS

m (ft)	1,20	3,95	1,63	5,33	2,40	7,87	3,00	9,84
4GS-62 kg (lbs)	20,00	44,00	28,00	61,60	40,00	88,00	51,00	112,20

connection material (pins/clips) and packaging not included in above weights

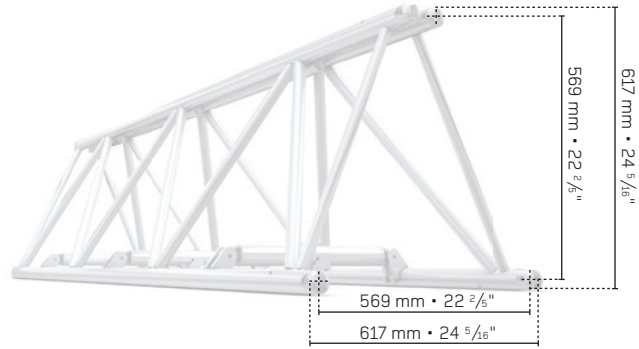

4GS-62F

connection type	fork end connection	tubes	48 x 4,5 mm	1 7/8" x 3/16"	braces	25 x 3 mm 32 x 3 mm	1" x 1/8" 1 1/4" x 1/8"	alloy	EN - AW 6082 T6
------------------------	---------------------	--------------	-------------	----------------	---------------	------------------------	----------------------------	--------------	-----------------

Special structures available. Powder coating to RAL reference.

4GS-62F																		
Span in m (ft)	4,80	15,75	7,20	23,62	9,60	31,50	12,00	39,37	14,40	47,25	16,80	55,12	19,20	63,00	21,60	70,87	24,00	78,74
point load in kg (lbs)	1493,50	3293,17	1290,00	2844,45	1179,60	2601,02	1048,60	2312,16	953,30	2102,03	858,00	1891,89	747,60	1648,46	715,00	1576,58	675,00	1488,38
deflection in mm (inch)	8,00	0,31	18,00	0,70	33,00	1,29	51,00	1,99	73,00	2,85	100,00	3,90	130,00	5,07	165,00	6,44	204,00	7,96
two point load in kg (lbs)	1413,50	3116,77	1126,40	2483,71	988,80	2180,30	898,80	1981,85	789,80	1741,51	642,70	1417,15	588,80	1298,30	560,40	1235,68	521,80	1150,57
deflection in mm (inch)	10,00	0,39	23,00	0,90	42,00	1,64	65,00	2,54	94,00	3,67	127,00	4,95	166,00	6,47	211,00	8,23	260,00	10,14
distrib. loading in kg/m (lbs/ft)	610,50	410,29	443,20	297,85	329,00	221,10	227,00	152,56	154,00	103,50	130,80	87,90	97,30	65,39	74,40	50,00	58,00	38,98
total distrib. loading in kg (lbs)	2930,40	6461,53	3191,00	7036,24	3158,40	6964,27	2724,00	6006,42	2217,60	4889,81	2197,40	4845,36	1868,20	4119,29	1607,00	3543,52	1392,00	3069,36
deflection in mm (inch)	10,00	0,39	18,00	0,70	30,00	1,17	68,00	2,65	92,00	3,59	125,00	4,88	163,00	6,36	206,00	8,03	254,00	9,91

STANDARD LENGTHS AVAILABLE AND WEIGHTS

m (ft)	1,20	3,94	1,63	5,33	2,40	7,87
4GS-62F kg (lbs)	19,00	41,80	25,00	55,00	37,00	81,40

connection material (pins/clips) and packaging not included in above weights

metric data imperial data

point load in kg (lbs) 

two point load in kg (lbs) 

distrib. load (UDL) in kg/m (lbs/ft) 